

**DUSTER**



**Quick Info**

CRI ≥ 90

3000K/ 4000K/ 5700K

ON-OFF/ON-OFF (FLICKER FREE)

DALI-2 DT6, DALI-2 DT8, DALI+

SDCM<3

Lens

L70 @50,000h

**Types**

Recessed

**Single Line Diagram**

Duster-40

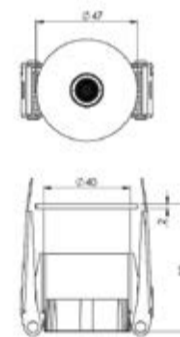

Duster-52

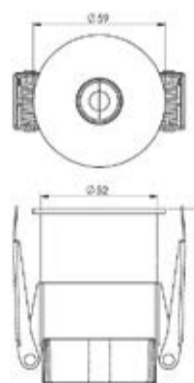

**DUSTER DOWNLIGHT**

Duster Downlight features has:

- Die cast- aluminium Luminaire housing
- Premium powder coated finish
- COB (Chip on Board) technology with Lens
- Available in Fixed version
- LED with effective colour rendering
- Precision-engineered, electroplated and nano-plated reflector
- Zero multiple shadows
- Unique pull ring design

**Light Distribution**

Direct

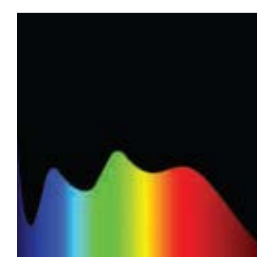

CRI ≥ 90



TUNABLE  
WHITE

**335**

## DUSTER



### DUSTER -40

System Power	Dimension
5W	Outer Dia- 47mm, Cutout Dia- 40mm, Height- 59mm

### DUSTER -52

System Power	Dimension
8W	Outer Dia- 59mm, Cutout Dia- 52mm, Height- 78mm
10W	Outer Dia- 59mm, Cutout Dia- 52mm, Height- 78mm

## Order Options

### CCT (Colour Temperature)

3000K

4000K

5700K

Tunable White 2700K-6500K



### CRI

>90

### Beam Angle

24°

36°

### Control

ON-OFF



ON-OFF (FLICKER FREE)



DALI-2 DT6



DALI-2 DT8



DALI+



### Mounting

Recessed

### Material Colour

RAL As Per Request